

RESTORATION GUIDE

TritoFlex™ 1K S Rubber – Roof Restoration System

Warranty Period	10 Years		15 Years		20 Years	
	Min Dry Mils	Coverage Rate	Min Dry Mils	Coverage Rate	Min Dry Mils	Coverage Rate
TritoFlex 1K S Rubber	40	24 sf/gal	60	17 sf/gal	80	12 sf/gal
Top Coat	20	50 sf/gal	20	50 sf/gal	30	33 sf/gal
Granulated 1K	10	100 sf/gal	10	100 sf/gal	N/A	N/A

**Acrylic top coat is required for any warranty in DOE Zones 1-4*

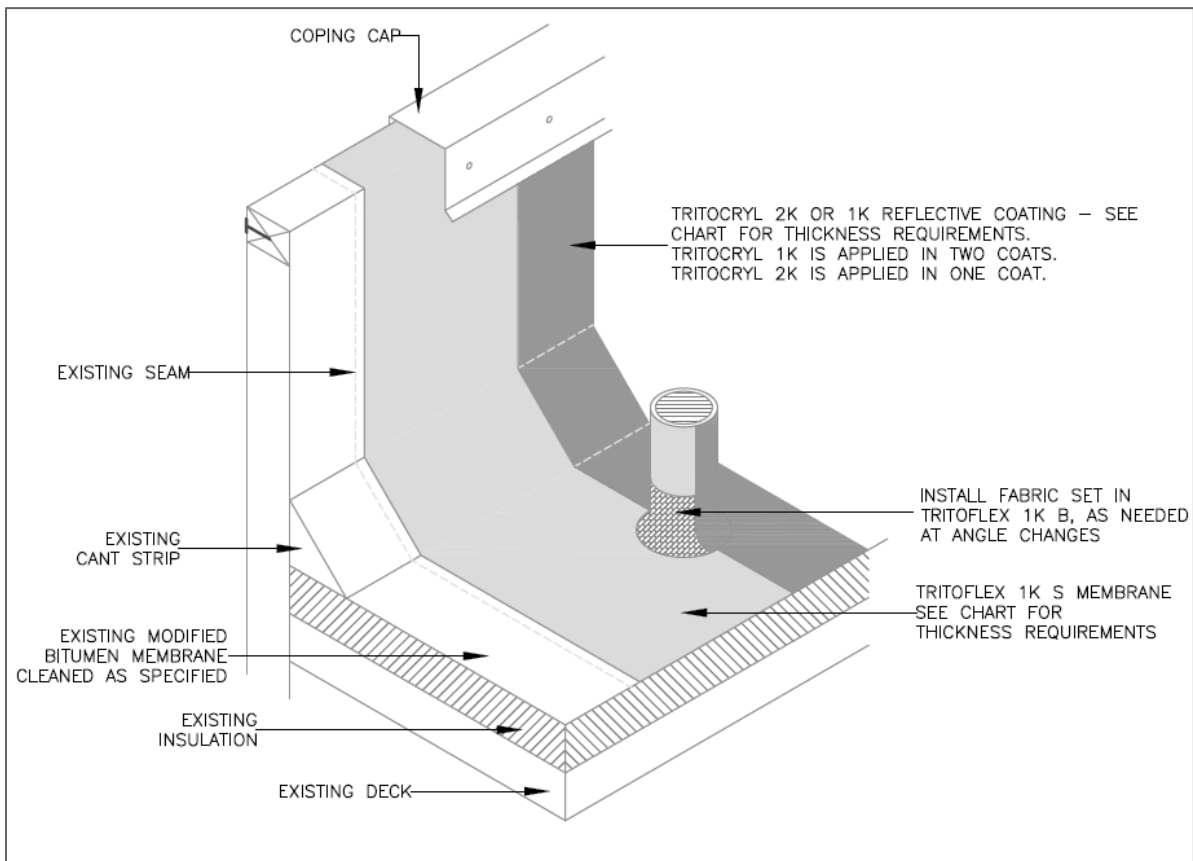

Typical Roof Detail

RESTORATION GUIDE

TritoFlex™ 1K S Rubber Restoration System

The non-toxic TritoFlex 1K seamless roofing system is ideal for restoring existing PVC, TPO, EPDM, or Hypalon single-ply roofs when they are worn-out and leaking. Using a liquid membrane restoration avoids a costly, disruptive tear-off. At only 7 oz/sf, it is lightweight and applied quickly. The liquid rubber product forms a new flexible, durable, fully-adhered, and monolithic waterproofing membrane over the existing roof without needing thousands of screws or glue.

Advantages:

- ✓ Roof can be renewed indefinitely
- ✓ Non-disruptive and odor-free installation
- ✓ 1200% elongation, with 660 psi tensile strength
- ✓ Remains flexible in sub-zero temps
- ✓ Seamless, self-terminating
- ✓ Extremely durable and long-lasting

Quick Guide

Inspection

- Check the existing membrane for areas of damage or deterioration
- Scan the insulation for moisture content. In most cases, saturated insulation must be cut-out and replaced
- Check for proper adequate slope and proper drainage

Cleaning & Repairs

- Remove any wet or saturated areas of insulation. Repair with new insulation and new membrane to match existing roofing material
- Pressure wash entire surface to ensure roof is free of moisture, loose dirt, grease, and debris. For EPDM surfaces less than 10 years' old, apply EPDM Lap Primer after washing.
- Loose seams, large gaps, and voids must be repaired or patched with new material to match existing or TritoFlex 1K B (allow to fully cure for 24 hours)
- Install one-way vents every 1,200 sf after cutting a 4" diameter hole to vent

Pre-Detailing Application

- Brush apply TritoFlex 1K B, embedding 4" Triton

polyester fabric, around all penetrations, curbs, flashings, joints, drip edge, and angle changes.

- Apply a layer of TritoFlex 1K B into all seams at minimum 50 wet mils. On EPDM substrates, seams must be reinforced with fabric.

Membrane & Topcoat Application

- After TritoFlex 1K B has fully cured, spray apply first coat of TritoFlex 1K S at 30 wet/18 dry mils over all surfaces
- Allow first coat to cure for 6-12 hours, then apply second coat of TritoFlex 1K S at 35 wet/22 dry mils to achieve finish of 40 dry mils. Third coat is required for 60/80 mil systems.
- After TritoFlex 1K is fully cured, apply first coat of TritoCryl 1K reflective topcoat. If spraying, back-roll the first coat and apply to 15 wet mils.
- Apply second coat of topcoat to 15 wet/10 dry mils. Prevent water from ponding for 48 hours.
- If applying a granulated topcoat, broadcast 50 lbs. of granules every 100 sf into a wet 15 mil layer of TritoFlex 1K S. Blow all loose granules off and collect for re-use after fully cured.
- In areas where the roof is subject to foot traffic, apply liquid TritoWalk coating to create walkways. Apply by roller at 5 gallons/100 sf in two coats for a total of 50 mils dry