

# INSTALLATION GUIDE

## TritoFlex 2K Rubber - Warranty Options

| Warranty Period     | 10 Years     |               | 15 Years     |               | 20 Years     |               |
|---------------------|--------------|---------------|--------------|---------------|--------------|---------------|
|                     | Min Dry Mils | Coverage Rate | Min Dry Mils | Coverage Rate | Min Dry Mils | Coverage Rate |
| TritoFlex 2K Rubber | 60           | 17 sf/gal     | 60           | 17 sf/gal     | 80           | 12 sf/gal     |
| Top Coat            | 20*          | 50 sf/gal     | 20           | 50 sf/gal     | 30           | 35 sf/gal     |
| Granulated 1K       | 10           | -             | -            | -             | -            | -             |

\*Acrylic top coat is required for any warranty in DOE Zones 1-4

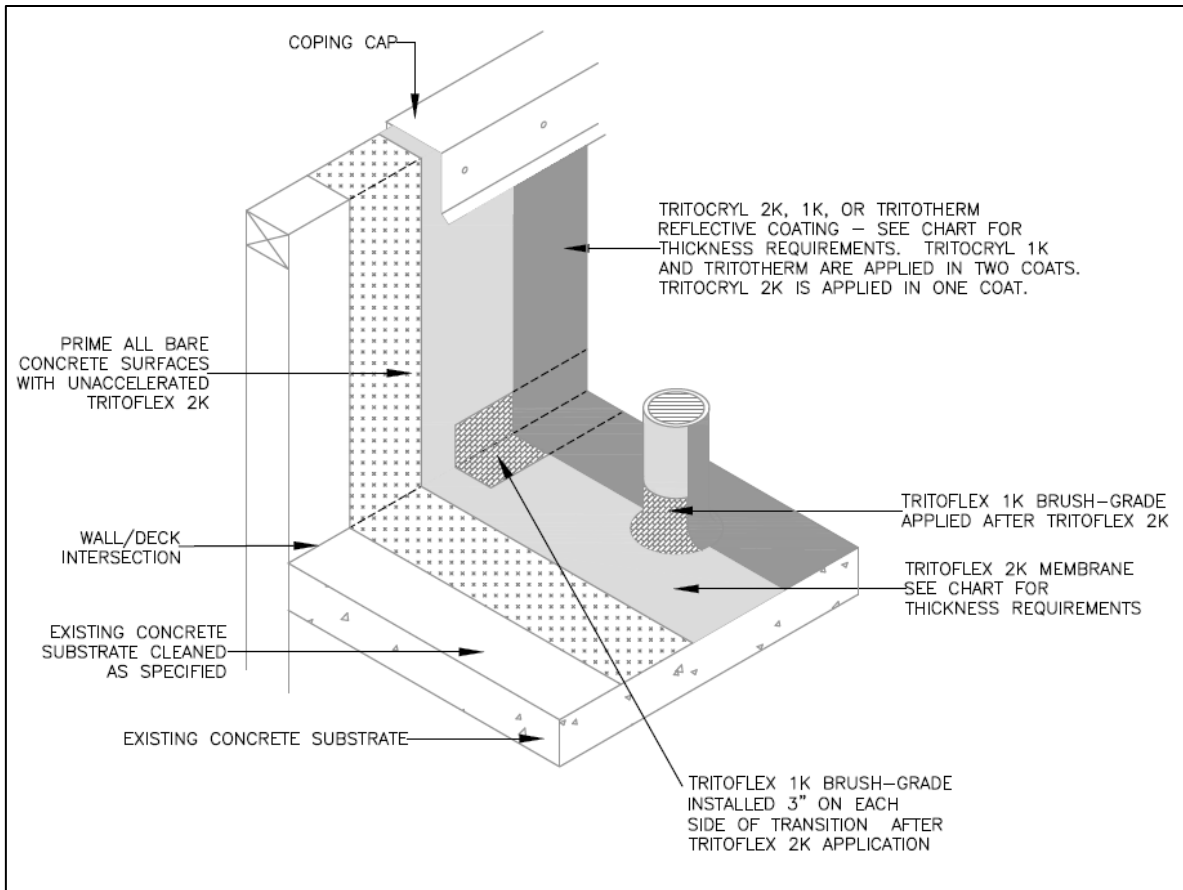

# INSTALLATION GUIDE

## TritoFlex 2K Rubber System

The TritoFlex 2K rubber membrane is ideal for creating a durable, monolithic waterproofing membrane over a new or existing concrete roof substrate. TritoFlex 2K withstands ponding water indefinitely and is cold spray-applied to any thickness in one coat. The liquid rubber product forms a thick, durable, fully-adhered membrane without the need for screws or glue to hold it down. Finished with the TritoCryl reflective topcoat, it becomes an energy efficient, sustainable roof system.

### Advantages:

- ✓ Withstands ponding water indefinitely
- ✓ Sprayed to any thickness
- ✓ Water-based, no VOC's, no odor
- ✓ Instantly rain-resistant
- ✓ FM tested and approved
- ✓ Over 1100 % elongation and very durable
- ✓ Seamless, self-terminating

## Quick Guide

### Inspection

- Check the existing substrate for areas of damage or deterioration that may need repaired
- Check for moisture content using the plastic sheet method or moisture scanning tool

### Preparation

- Pressure wash or air blast entire surface to ensure roof is free of moisture, loose dirt, oils, grease, and debris. Remove any loose or peeling coatings or mastics that may exist.
- Over bare concrete areas, apply TritoFlex 2K liquid with no Accelerator as a primer coat at 10 wet mils and allow to dry 30 minutes.
- Concrete cracks over 1/8" in width should be repaired using an approved quick-set mortar or TritoFlex 1K and fabric.

### Application

- Spray apply TritoFlex 2K at minimum mil thickness specified, starting at the low spots. Check for proper millage using the Triton mil thickness gauge. Re-spray spot where measurements are taken immediately to seal. If thickness was low, re-spray over area and measure again.
- Apply TritoFlex 1K Brush-Grade to seal edges of flashings, 90-degree angles, curbs, pipes, and where any visual imperfections existing. Apply at 97 wet/60 dry mils
- After TritoFlex products have fully dried, rinse off dried accelerator from the surface
- After TritoFlex 1K is fully cured, apply first coat of TritoCryl 1K/2K or TritoTherm reflective sacrificial top coat. If spraying, back-roll the first coat and apply to 15 wet/10 dry mils.
- When using TritoCryl 2K as the top coat, only one coat is needed at 30 wet/20 dry mils
- Apply second coat of top coat to 15 wet/10 dry mils. Prevent water from ponding for 48 hours.
- If applying a granulated top coat, embed 50 lbs. of granules every 100 sf into a wet 15 mil layer of TritoFlex 1K